

Double-head led motion sensor security light

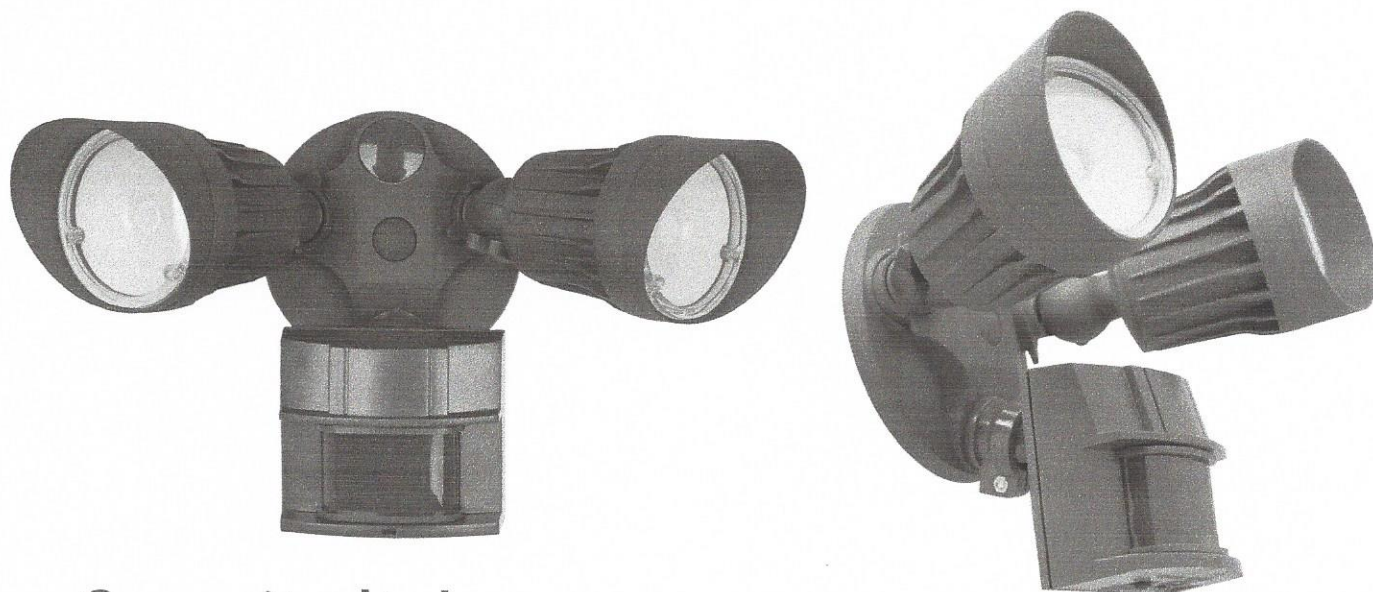

Security light parameters:

Product name :	led security light	LED Q'ty:	2 pcs
Model:	SES-HG70-20W	Applicable environment:	Dry/wet location
driver:	non-isolated driver	Cover type	Transparent PC
Power:	20W	color:	White/brown
Voltage:	90-135V 50/60Hz	lumen:	1500LM
Product size:	144*169*145mm	light efficiency:	75LM/W
CRI:	Ra≥80	Package:	260*190*155mm
C C T:	3000K、4000K、5000K、6000K	Q'TY:	4*2*1=8pcs
Source :	COB (HongLi LM-80)	N.W.:	700.5g
Beam angle:	100°	G.W.:	

Features:

- Led source use high bright LED chip, energy saving and pro-environment, lighting stable and long lifespan.
- Optical-grade PC lampshade, the light is good, anti-aging, difficult to damage;
- High heat conduction aluminum alloy shell, good heat dissipation, vacuum dust-free spray, anti-corrosion, no stripping;
- Strict waterproof treatment technology, meet international waterproof and dustproof standards;
- Can three-dimensional rotate, wide rotation angle, flexible and convenient adjustment;
- Radiate light protection design, won't affect the lighting effects because of weather.
- Sensor angle is adjustable, long sensor distance, high sensor sensitivity.

Light Source Test Report:

Color Parameters:

Chromaticity Coordinate: $x=0.4325(dx=-0.0009)$ $y=0.4009(dy=-0.0019)$
 Chromaticity Coordinate: $u'=0.2491$ $v'=0.5195(duv=-6.59e-04)$
 $T_c=3050K$ Dominant WL: $L_d=582.8nm$ Purity=50.1% Centroid WL: $588.0nm$
 Ratio: $R=24.2\%$ $G=73.1\%$ $B=2.7\%$ Peak WL: $L_p=600.0nm$ HWL: $124.3nm$
 Render Index: $R_a=81.4$
 $R1=80$ $R2=92$ $R3=94$ $R4=77$ $R5=80$ $R6=90$ $R7=81$
 $R8=56$ $R9=3$ $R10=82$ $R11=75$ $R12=70$ $R13=83$ $R14=98$ $R15=73$

Photo Parameters:

Flux: 1557.6 lm Fe: 4.7253 W Efficacy: 78.95 lm/W

Electrical Parameters:

Luminaire: $U=110.2V$ $I=0.1854A$ $P=19.73W$ $PF=0.9651$

Instrument Status:

Scan Range: $380.0nm-800.0nm$ Interval: $5.0nm[0]$ $I_p=17590(G=4,D=56)$
 REF=53458(R=3) $\%=-0.135\%$ PMT: 30.1 centigrade [150.0]

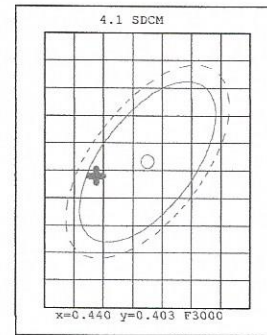
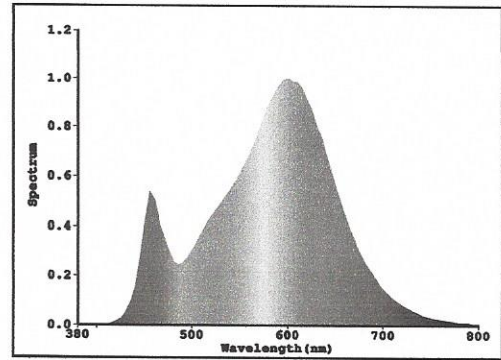

Installation method:

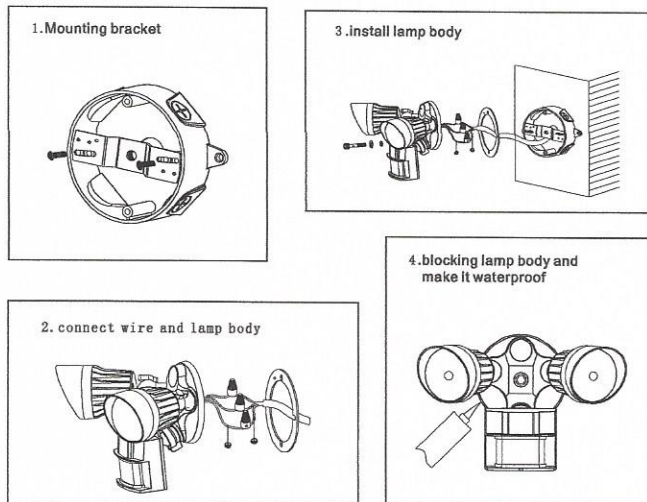

Installation effect diagram:

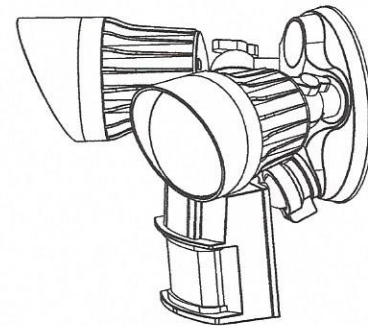

Warning: Risk of electrical shock

Turn off electrical power at fuse or circuit breaker box before wiring fixture to the power supply; Verify that supply voltage is within right and reasonable limits. Connect the fixture with 120V 60Hz power supply; Make all electrical and grounded connections in accordance with the National Electrical Code and applicable local code requirements; All wiring connections should be capped with UL approved wire connections.

Warning: Risk of burn

Wear gloves and safety glasses at all times when moving luminaire from carton, installing, servicing or performing maintenance; Avoid direct eye exposure to the light source while it is on. LED lights are very bright. Do not stare LED light beam in any case. Or this may cause irreparable damage to the eyes.; Allow fixture to cool before handling. Do not touch enclosure or light source; Do not exceed maximum wattage marked on luminaire label.

Warning: beware of fire

Keep combustible and other materials that can burn away from lamp/lens..